

SPP200

Phono Preamp

SKU:358237

NEW

The **SPP200** is a **Phono Preamp** which accentuates your record player's output up to the correct line level, with one pair of RCA inputs, and outputs on both RCA and stereo 1/4" connectors. SPP200 ensures your record player operates correctly with the rest of your gear.

- Preamp Type: Solid State
- Number of Channels: 1
- Analog Inputs: 1 x stereo RCA
- Analog Outputs: 1 x stereo RCA, 1 x 1/4"

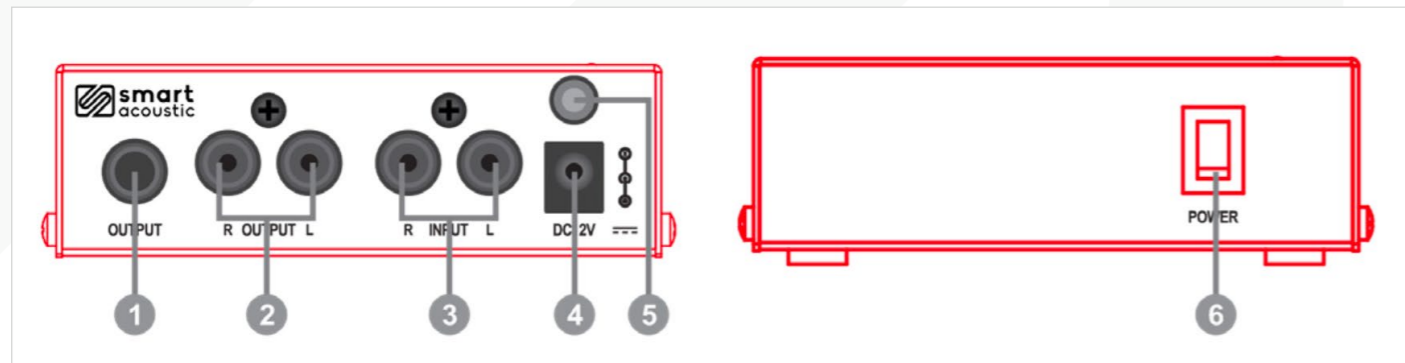

1. OUTPUT:

1/4" Tip-Ring-Sleeve jack for connection to a stereo amplifier, mixer or recording unit.

2. OUTPUT (L+R):

Stereo RCA jacks for connection to a stereo amplifier, mixer or recording unit.

3. INPUT (L+R):

Stereo RCA jacks connect to the phono player.

4. POWER INPUT:

12-16 Volts DC, tip negative jack.

5. GROUND CONNECTOR:

Connects to the ground of the phono player.

4. ON/OFF POWER SWITCH:

Switch the SPP200 on or off.

